

PIN MILL FOR FINE PRODUCTS AND COATING

Finest in Classifying

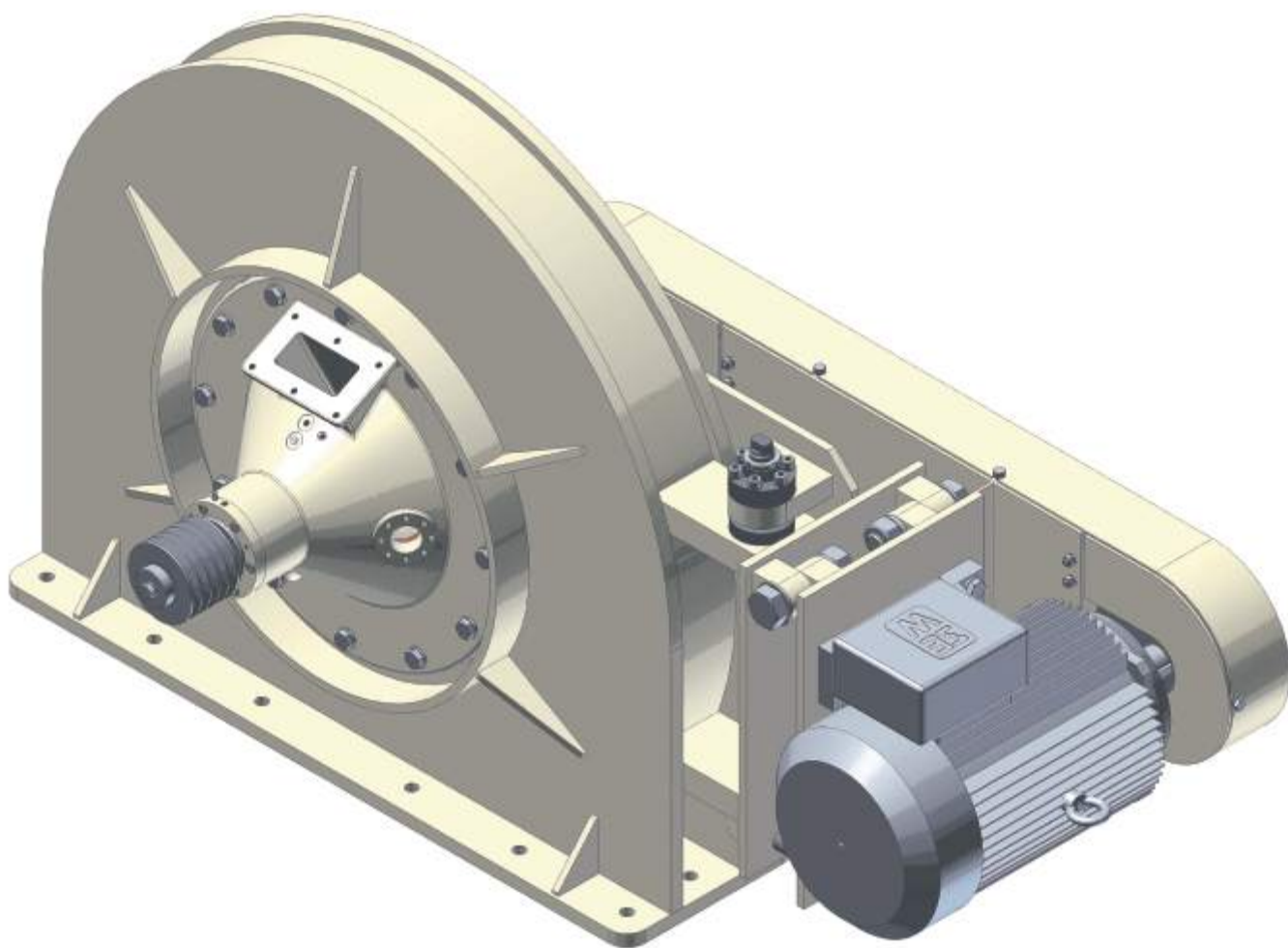

On the SMW pin mill both sets of pin discs are driven, either in the same or in opposite directions

With contra-rotating pin discs the resultant tip speed is over 200 m/s which enables the grinding of soft to medium hard minerals to a high fineness. Independent control of the speed and direction of rotation of the pin disc drives gives a high degree of flexibility. An airflow through the mill assists the grinding, enables the control of product temperature and provides a medium for pneumatic transfer of the product.

As standard, the mill body is a robust, welded mild steel construction. Where necessary, the SMW pin mill can also be offered in stainless-steel construction. Access on the SMW mill is excellent and pin replacement is an easy operation.

The SMW mill also represents an economical and highly efficient method of coating ultra-fine fillers with stearic acid.

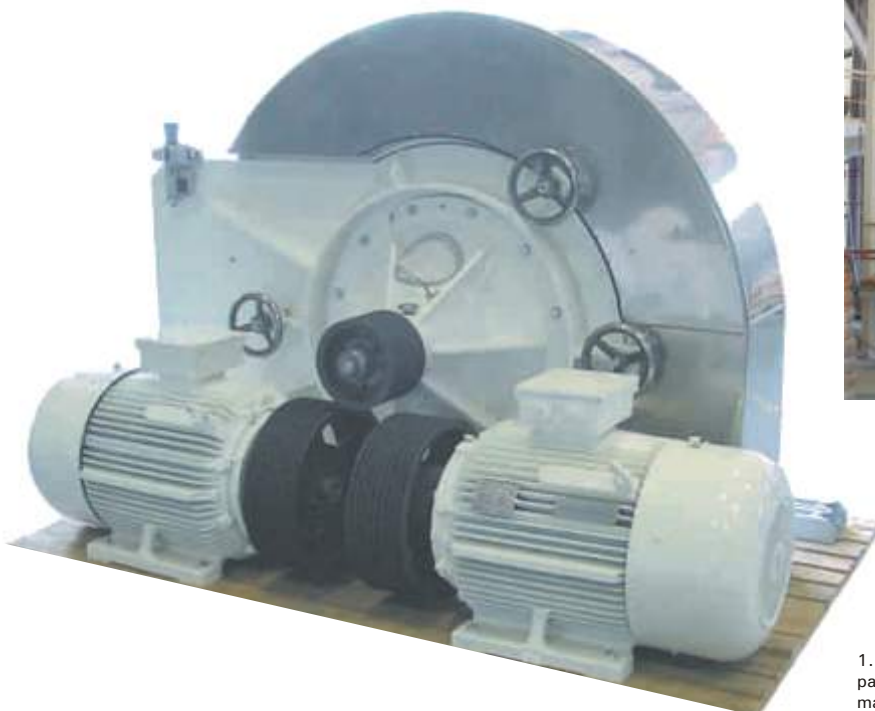

2. SMW 63 in a coating installation

1. SMW 63 special design: parts with contact to material made of stainless steel

BENEFITS

1. Fine grinding of soft and medium hard minerals
2. Extremely reliable and robust design
3. Pin discs counter rotation or same rotation depending on material and application requirements
4. Easy and quick maintenance resulting in low maintenance cost
5. Suitable for coating applications



2. SMW 63 in a coating installation with stearic acid melting vessel



4. Pin disc

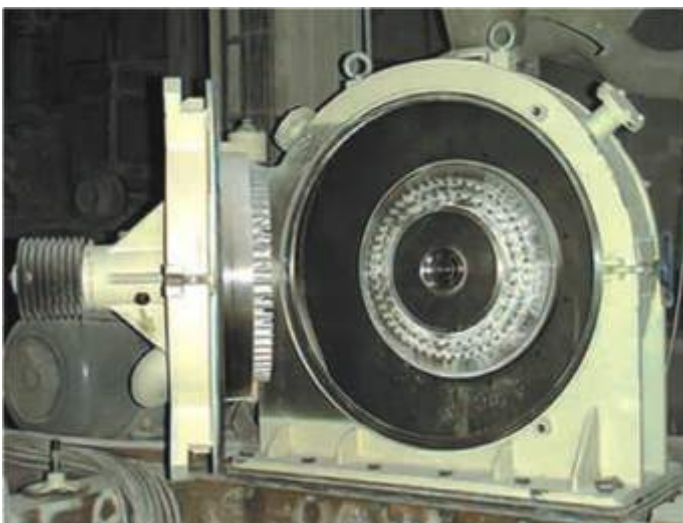

3. Open SMW 40 for CaCO₃ grinding



5. SMW 63