



# CEMTEC

Cement & Mining Technology

## CEMTEC

References

01/2011

# Zementwerk Berlin (ZWB)

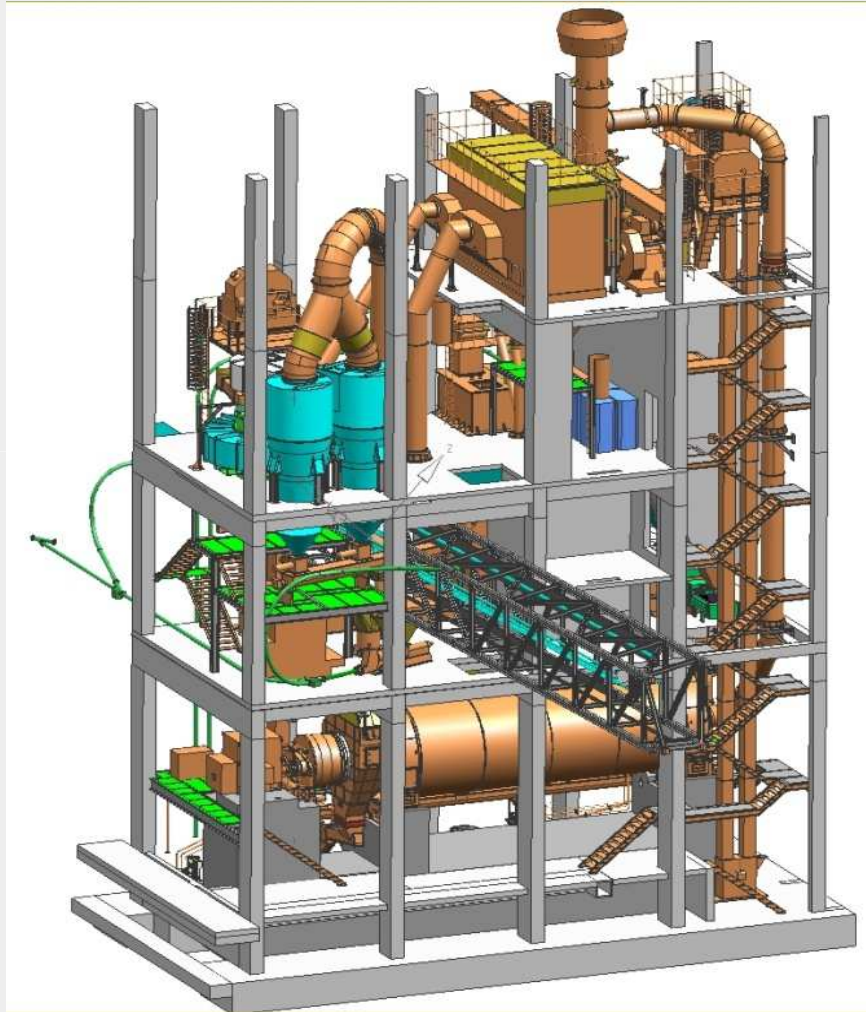

CEMENT GRINDING PLANT 50 t/h



# ZWB - Scope

---

- Year of Contract: 2009  
Year of Commissioning: 2010
- Project Scope:  
Engineering, Equipment & steel structure supply, erection and commissioning
- Equipment Basic Data:  
50 t/h OPC @ 3.200 Blaine  
Ball mill  $\varnothing 3,4 \times 10,0$  m with 1.500 kW installed power, 3rd gen separator with 90.000 m<sup>3</sup>/h, product separation with cyclones

# ZWB - Flow sheet

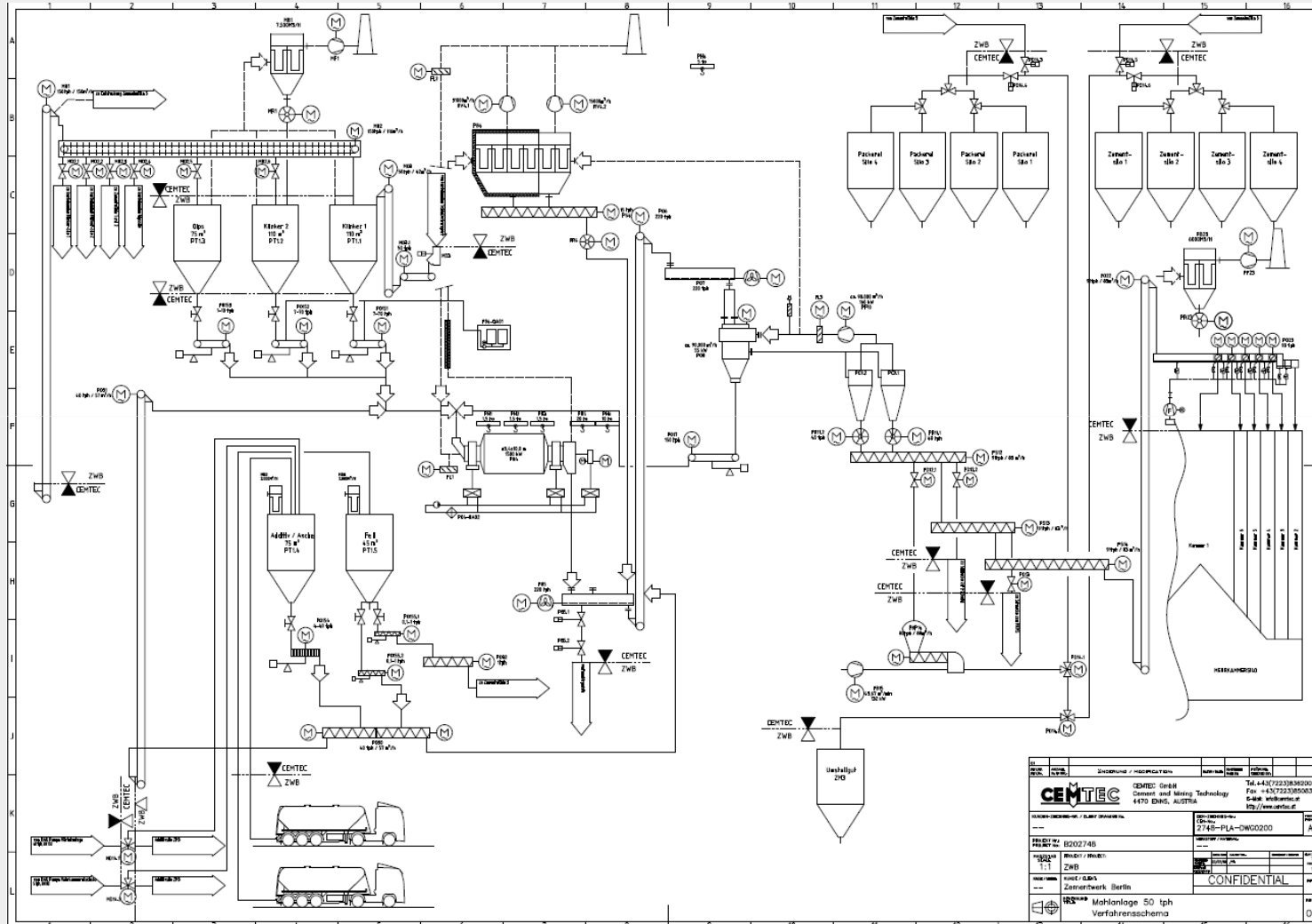

Sonderdruck / Modifikation		Rev. no.	Rev. date	Rev. desc.
<b>CEMTEC</b>		CEMTEC GmbH Cement and Mining Technology 6470 EMS, AUSTRIA		Tel. +43 7323383000 Fax. +43 7323385083 E-Mail: info@cemtec.at CEMTEC
PROJEKT-NR. / LAUF-NR.		2748-PLA-DW02000		A1
PROJEKT-NR.		B202748		
Revizur / Modif.		ZWB		
Ausgearbeitet von		CEMTEC GmbH		
Gezeichnet von		Zementwerk Berlin		
Geprüft von		CONFIDENTIAL		
Gezeichnet von		Mahlanlage 50 t/h		
Gezeichnet von		Verfahrensschema		

# ZWB – Isometric view

